

The medical gas outlet is the wall source for medical gases.
And it's the end of the medical piping system on the wall.

DESCRIPTION

- Outlet kind: Oxygen-nitrous oxide - Air (4bar) - Air (7bar) - vacuum ... etc
- Flow rate: 160L/min
- Work pressure: from 3.8 bar to 4.5 bar
- Maximum work pressure: double of work pressure.
- The outlet designed: French, British & German standard and available for :
 - Surface mounting
 - Bed head unit mounting
 - Ceiling pendant mounting
- The outlet has double valve (one in the socket and the other in the first)

90901896 - O2	AFNOR Oxygen outlet	90901897 - O2	BS Oxygen outlet	90901898 - O2	BS Oxygen outlet
90901896 - VIDE	AFNOR Vacuum outlet	90901897 - VIDE	BS Vacuum outlet	90901898 - VIDE	BS Vacuum outlet
90901896 - Air (4 bar)	AFNOR Air (4 bar) outlet	90901897 - Air (4 bar)	BS Air (4 bar) outlet	90901898 - Air (4 bar)	BS Air (4 bar) outlet
90901896 - N2O	AFNOR N2O outlet	90901897 - N2O	BS N2O outlet	90901898 - N2O	BS N2O outlet
90901896 - Air (7 bar)	AFNOR Air (7 bar) outlet	90901897 - Air (7 bar)	BS Air (7 bar) outlet	90901898 - Air (7 bar)	BS Air (7 bar) outlet
90901896 - Nitrogen	AFNOR Nitrogen outlet	90901897 - Nitrogen	BS Nitrogen outlet	90901898 - Nitrogen	BS Nitrogen outlet





OUTLET: TECHNICAL VIEW

1. Fixed Nut: manufactured From brass Plated from Nickel Krum and it`s function is collecting all parts of outlet.
2. Cover: manufactured From (Aluminum or Plastic) and Have sticker which mentions the kind and the color of the gas.
3. Box: manufactured from Plastic and the main Purpose from it is Protecting all Parts of the outlet.
4. Fixed Nut: manufactured from brass. It's function is collecting the Socket Part and the First part.
5. The Socket: manufactured from brass:
 - The second valve which contact with the prop
 - The socket is Difference From gas to another
6. Chaise: manufactured from stainless steel .main Purpose is Fixing all the outlet on the wall.
7. The First: manufactured from brass and it's function is working As a main valve for the outlet when there is any Emergency case.

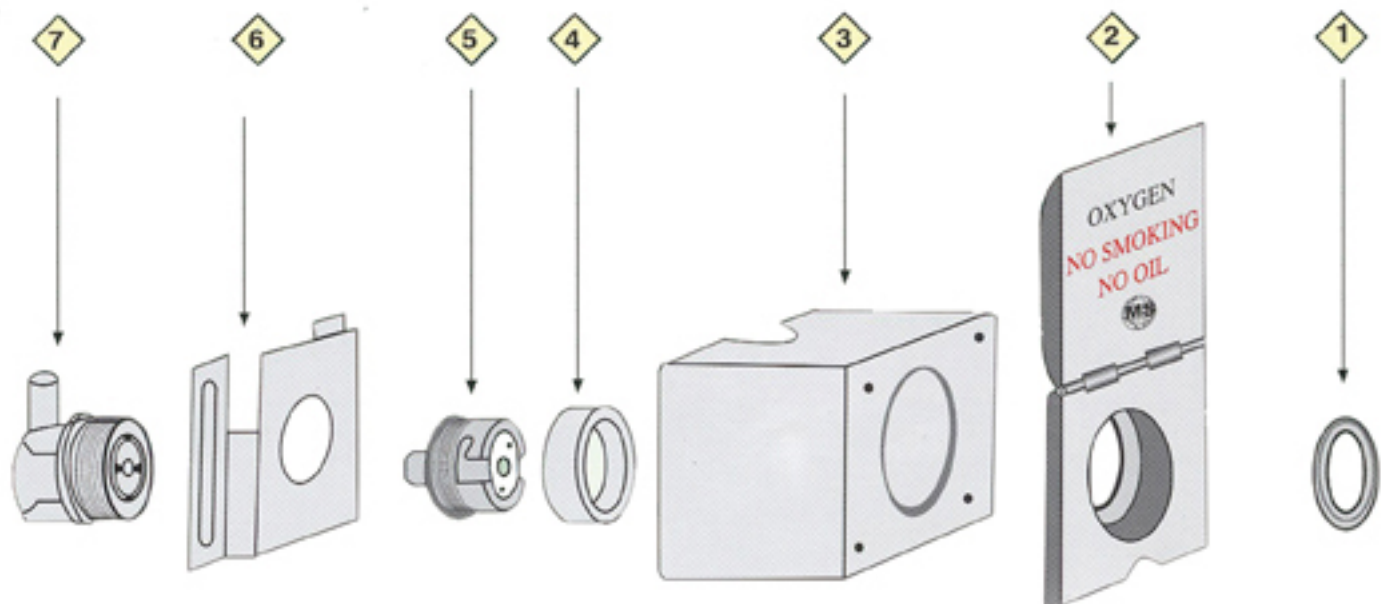

SOCKET VALVE: TECHNICAL VIEW

5-1 O-ring: manufactured from silicon and the main purpose of it is prevent leakage between the outlet and the prop.

5-2 Body: manufactured from brass plated from nickel Krum it work as a Pass for collecting all parts of the socket valve.

5-3 O-ring: Silicon ring prevent leakage between the outlet collecting body and socket valve.

5-4 O-ring: Silicon ring: Prevent leakage in the socket valve area.

5-5 Socket valve: manufactured from brass plated with Nickel Krum work as a pusher for the spring in the socket body.

5-6 Filter: Stain lees steal filter and it be inside the socket valve

5-7 Spring: manufactured from plated steal.

5-8 Fixed body: manufactured from brass plated with Nickel Krum and the main purpose of it collecting all parts of the socket inside it.

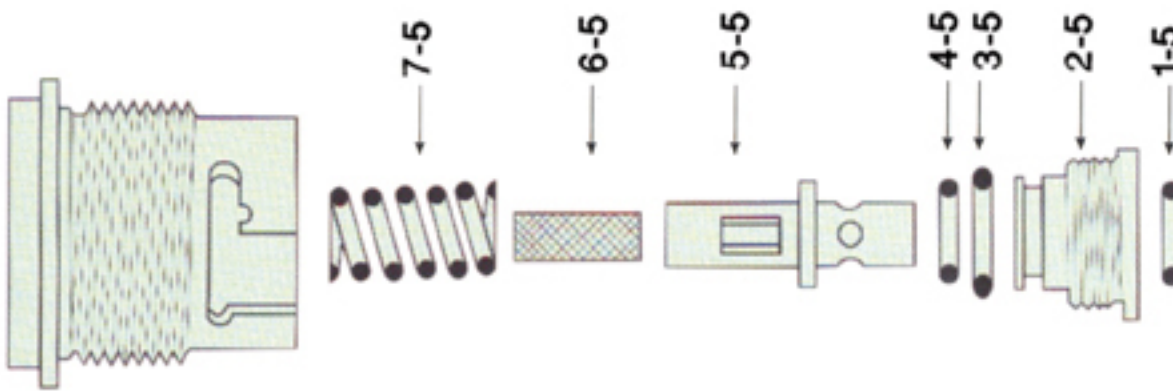

FIRST VALVE: TECHNICAL VIEW

7-1 Body: manufactured from brass main purpose is to collect all part of first valve.

7-2 O-ring: Silicon ring to prevent leakage between first valve body and all internal parts of it.

7-3 O-ring: Silicon ring to prevent gas leakage between the pusher and the end of the valve.

7-4 First pusher: manufactured from brass plated with nickel Krum work as a pusher for the spring into the first valve body.

7-5 Spring: manufactured from plated steal.

7-6 Connecting pipe: manufactured from brass to connect the outlet with piping system.

